

At _____ M
THOMAS M. LEIGHTON
REGISTER OF DEEDS

Recorders Data

This form is intended to fulfill the requirements of Chapter A-E7.08 (3)(a) thru (i) U.S. Public Land Survey Monument Location Record, Wisconsin Administrative Code. Use the reverse side of form for continuation.

U.S. PUBLIC LAND SURVEY MONUMENT LOCATION RECORD

USPLS CORNER: WEST WITNESS MC SECTION: 32 TOWNSHIP: 39 NORTH RANGE: 10 EAST

NAME OF WATERWAY FOR M.C. CORNER : COLUMBUS LAKE SECTION LINE: NORTH

~~(CITY)~~(VILLAGE)(TOWN) OF: SUGAR CAMP COUNTY OF: ONEIDA

Description of monument found or placed and all other evidence used as the basis for monument location; including monuments and measurements required if the corner location was reestablished by lost corner proportionate methods. Also indicate name of the original surveyor, original survey date and the corner monument, bearing trees, witness or other reference monuments established, including measured bearing and distance ties, from available survey records.

Found and accepted a plumb and secure old 1" dia. iron pipe with uncapped top 11" above grade, which I left in place and drove a standard 2" dia. by 30" long aluminum pipe monument with stamped Oneida County cap over it to 8" above grade; the corner falls 20' West of existing lakeshore bearing N20°E and South this date.

In October 1863, William E. Daugherty/GLO set a wood post as the original corner and noted OBTs: a 15" Pw S71°W 4 links and a 12" Hemlock N26°W 27 links; all are now obliterated.

In 1954, Forrest Wincentsen noted a 5" sq. wood post and Pine BT found at this Witness MC per Oneida County survey records.

In June 1982, Robert E. Bandow/RLS 104 indicates a 1" iron pipe found at this Witness MC per plat of survey filed as B-200 in Oneida County survey records.

In December 2003, Michael E. Weber/RLS 2070 notes a 1" iron pipe found in place at this Witness MC per plat of survey filed as A-1328 in Oneida County survey records.

This recovery completed August 6, 23004; there were no direct witnesses.

Plan view map of monument location with bearing and distance ties to a minimum of four(4) described witness or reference monuments of concrete, natural stone, iron, live bearing trees or equivalent material. If applicable, also show a minimum of two(2) bearing and distance ties to any other monument found and not accepted; including the bearing and distance from the accepted monument.

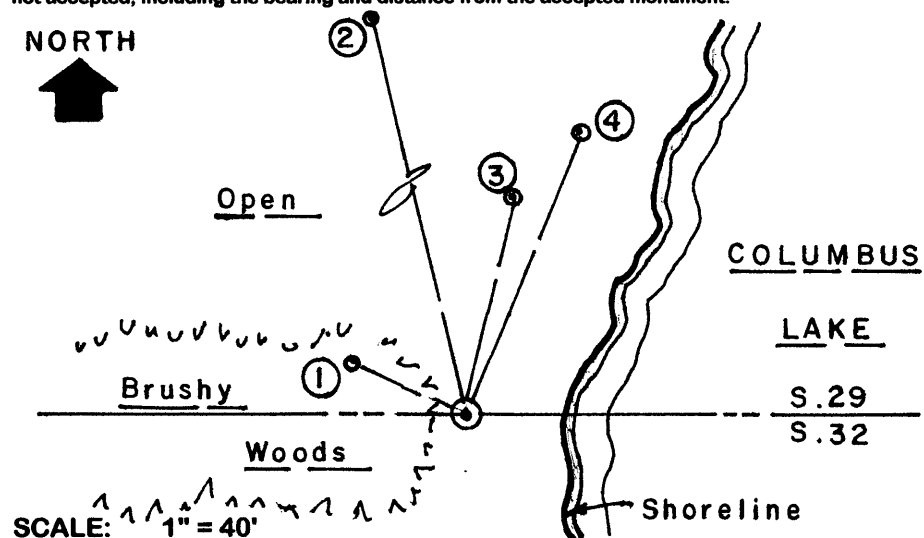

WITNESS MONUMENT TIES:

- ① New 5" Mr BT N65°W 26.63' to PK & washer in left face 30" above grade.
- ② New 20" Pw BT N14°W 93.40'.
- ③ New 11" Mr BT N12°E 46.08'.
- ④ New 8.5" Mr BT N22°E 63.69'.

Standard white poly 'T' marker post also found 8" West of corner.

I flagged monument and 'T' post blaze orange only.

Unless otherwise indicated, all bearing tree ties are to a .25" dia. by 2.5" long PK nail with a 1.25" dia. steel washer driven into unblazed right face and a .25" dia. by 2.5" long PK nail with a 2" dia. steel washer stamped BT is also driven into unblazed face of bearing tree at DBH; the basis for measured bearings is by compass to nearest degree and all tie distances are measured horizontal by steel tape corrected to nearest 1/100th feet at standard temperature of 68° F.

RLS SEAL:

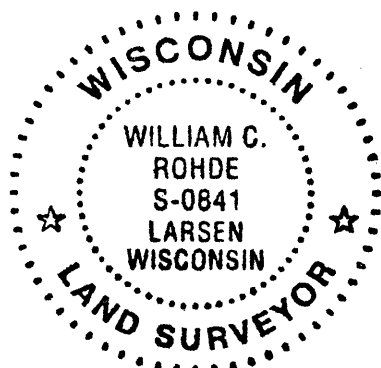

LAND SURVEYOR CERTIFICATE:

I, William C. Rohde, hereby certify that I am duly licensed as a Professional Land Surveyor in the State of Wisconsin; that this USPLS monument location was determined by me and/or under my direct supervision and control; and that this U.S. Public Land Survey Monument Location Record is true and correct to the best of my knowledge and belief.

Signed: *William C. Rohde*
William C. Rohde RLS 841

	T 39N		
	32		
	R 10E		

SECTION LOCATION MAP
INDEX NO. 7-8

Date Signed: September 4, 2004

3910290012