

WILLIAM C. ROHDE
TOWN CLERK
REGISTER OF DEEDS

This form is intended to fulfill the requirements of Chapter A-E7.08 (3)(a) thru (l) U.S. Public Land Survey Monument Location Record, Wisconsin Administrative Code. Use the reverse side of form for continuation.

U.S. PUBLIC LAND SURVEY MONUMENT LOCATION RECORD

USPLS CORNER: NORTH 1/4 SECTION: 6 TOWNSHIP: 38 NORTH RANGE: 10 EAST
 NAME OF WATERWAY FOR M.C. CORNER : N/A SECTION LINE: N/A
 (CITY)(VILLAGE)(TOWN) OF: SUGAR CAMP COUNTY OF: ONEIDA

Description of monument found or placed and all other evidence used as the basis for monument location; including monuments and measurements required if the corner location was reestablished by lost corner proportionate methods. Also indicate name of the original surveyor, original survey date and the corner monument, bearing trees, witness or other reference monuments established, including measured bearing and distance ties, from available survey records.

Found and accepted an undisturbed standard 2" dia. aluminum pipe monument with Oneida County cap 6" above grade as stamped and set in 1992 by William E. Bandow/RLS 1182 but no location record filed to date. Also found a standard white poly 'T' marker post 7" West. Other than an old BT found and noted below, no other BTs found nearby as the North edge of a wooded area is 200'+/- South of the corner, so I set three(3) rebar reference monuments on top of berm along south side of existing roadway as noted below. I flagged 'T' post, monument and reference rebars blaze orange. This corner also previously located per Oneida County GPS survey control records.

Corner falls in a low brushy timber harvest area about 57' South of the center of a gravelled roadway bearing N85°W & S80°E along a curve.

In July 1859, Hiram C. Fellows/GLO set a wood post as the original corner and noted OBTs: a 12" Birch S33°E 43 links and a 10" Birch N54°W 12 links; all are now obliterated.

In January 1992, William E. Bandow/RLS 1182 set a standard Oneida County capped aluminum pipe monument at this corner per plat of survey filed as B-2390 in Oneida County survey records.

This recovery completed August 4, 2004; there were no direct witnesses.

Plan view map of monument location with bearing and distance ties to a minimum of four(4) described witness or reference monuments of concrete, natural stone, iron, live bearing trees or equivalent material. If applicable, also show a minimum of two(2) bearing and distance ties to any other monument found and not accepted; including the bearing and distance from the accepted monument.

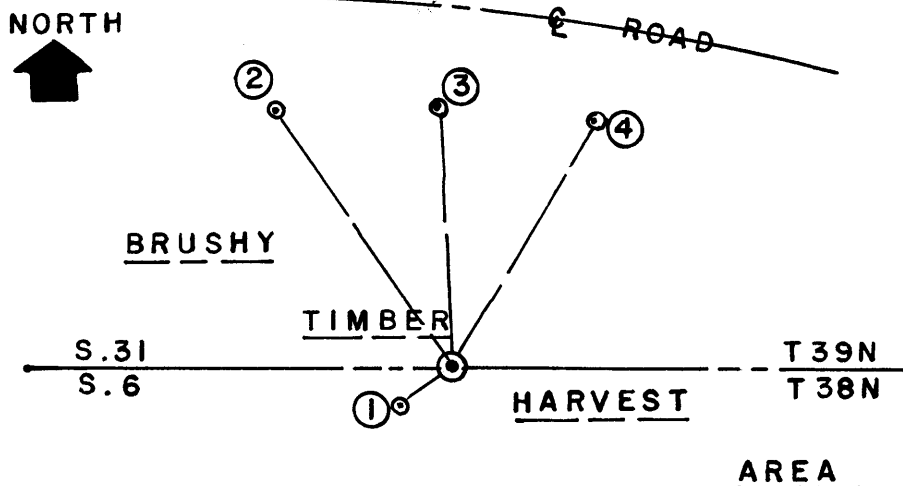

WITNESS MONUMENT TIES:

- ① Old 14" Hemlock BT S55°W 10.50' with upper and lower face blazes shut but scars plain; I nailed a standard BT sign to upper face and painted old face scars blaze orange.
- ② Set a 5/8" dia. by 24" long rebar with RM cap 4" up N35°W 49.08' on East side of a sawed stump.
- ③ Set a 5/8" dia. by 24" long rebar with RM cap 1" up N04°W 41.30'.
- ④ Set a 5/8" dia. by 24" long rebar with RM cap 1" up N29°E 44.15'.

SCALE: 1" = 30'

Unless otherwise indicated, all bearing tree ties are to a .25" dia. by 2.5" long PK nail with a 1.25" dia. steel washer driven into unblazed right face and a .25" dia. by 2.5" long PK nail with a 2" dia. steel washer stamped BT is also driven into unblazed face of bearing tree at DBH; the basis for measured bearings is by compass to nearest degree and all tie distances are measured horizontal by steel tape corrected to nearest 1/100th feet at standard temperature of 68° F.

RLS SEAL:



LAND SURVEYOR CERTIFICATE:

I, William C. Rohde, hereby certify that I am duly licensed as a Professional Land Surveyor in the State of Wisconsin; that this USPLS monument location was determined by me and/or under my direct supervision and control; and that this U.S. Public Land Survey Monument Location Record is true and correct to the best of my knowledge and belief.

Signed: *William C. Rohde*
 William C. Rohde RLS 841

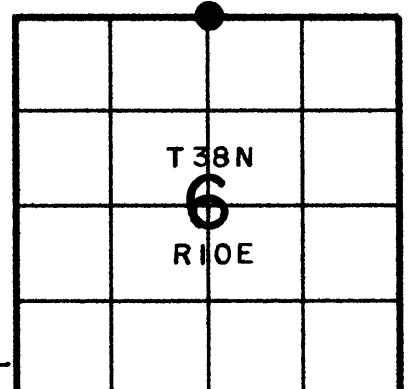

SECTION LOCATION MAP
 INDEX NO. 23