

# U.S. PUBLIC LAND SURVEY MONUMENT RECORD

Note: This form is intended and designed to fulfill all requirements of Wisconsin Administrative Code, Chapter A-E 5.02, U.S. Public Land Survey Monument Record (3) (a) (b) (c) (d) (e) (f) (g) (h) (i). An additional sheet may be added if necessary to conform with said requirements.

(a) Corner location: Township 39 North  
 Range 10 East ~~West~~  
 Town/~~City/Village~~ Three Lakes  
 County Oneida

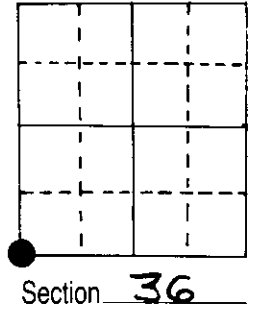

(b) (f) (g) (h) Description of monument found at this corner and if it was accepted, state all evidence (material, testimonial, occupational, plats, records, other monuments) used as a basis for accepting. If not accepted or if nothing was found, state evidence used as basis for establishing location. If reestablished through lost corner proportionate methods, indicate all monuments, distances and directions used to establish.

Original, 1859 Daugherty, OBT's Tam 6" N11°W 376 lks., Tam 8" N9°E 209 lks.  
 Tam 6" S38°E 170 lks., Tam 5" S60°W 61 lks.

Vaughn in 1901, found a post set by Monsell in road near culvert, found one BT, down, Some field notes said it was N 11°E 3.76. Set a post from this BT. This post is 2.00 ch south and 2.00 ch west from Mon.ell's. (comment-"maybe this is where the 2 ch error comes in on Vaughn's notes computation).

In 1976, Seymour & Copp computed a location for SW 36 using Vaughn distance factored to known correct lines. (NW 36 to W 1/8 on north line). Set 2" iron pipe w/ DNR brass cap. made BT's.

In 1987, Seymour found brass cap in good condition, BT's gone now. Made new BT's. Also set a tan painted cedar post 1' north of b.c.

Note- Vaughn's notes laid out show 2 ch error in west half.

(c) (d) (e) Plan view of corner with ties to at least 4 witness monuments. If in disagreement with previously established corner, show the distances between the two corners and also indicate the ties to the disputed corner.

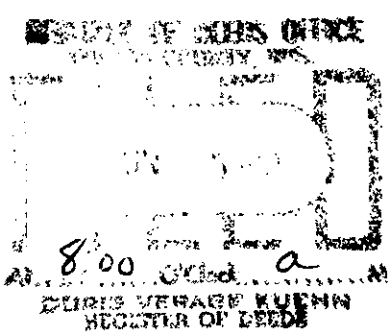
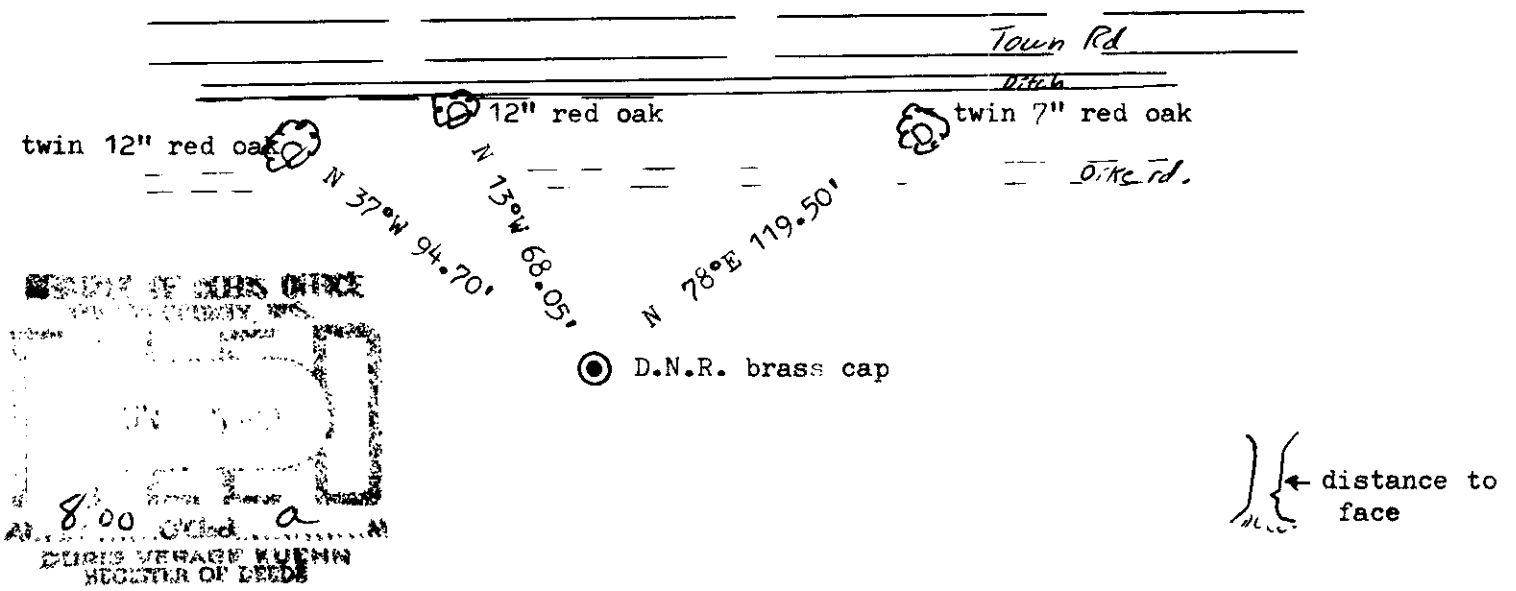

(i) I, Marvin E. Seymour  
 (type or print name) certify that the corner location on this record was determined by me or under my direction and control and that this U.S. Public Land Survey Monument Record is correct and complete to the best of my knowledge and belief.

Marvin E. Seymour  
 Signature  
May 18, 1987  
 Date

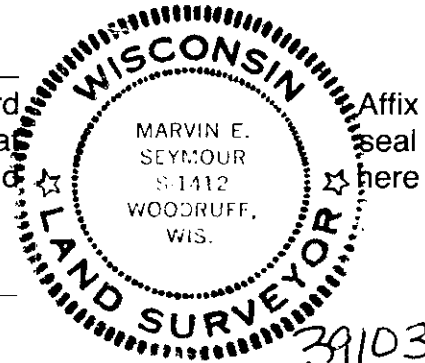

3910350000

2-21