

This form is intended to fulfill the requirements of Chapter A-E7.08 (3)(a) thru (i) U.S. Public Land Survey Monument Location Record, Wisconsin Administrative Code. Use the reverse side of form for continuation.

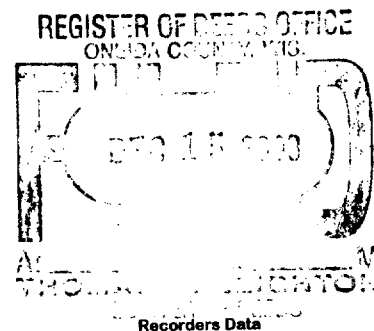

U.S. PUBLIC LAND SURVEY MONUMENT LOCATION RECORD

USPLS CORNER: WEST 1/4 CORNER SECTION: 9 TOWNSHIP: 39 NORTH RANGE: 11 EAST
 NAME OF WATERWAY FOR M.C. CORNER : N/A SECTION LINE: N/A
 (CITY)(VILLAGE)(TOWN) OF: THREE LAKES COUNTY OF: ONEIDA

Description of monument found or placed and all other evidence used as the basis for monument location; including monuments and measurements required if the corner location was reestablished by lost corner proportionate methods. Also indicate name of the original surveyor, original survey date and the corner monument, bearing trees, witness or other reference monuments established, including measured bearing and distance ties, from available survey records.

Found an undisturbed older 2" dia. galvanized iron pipe with stamped brass cap 20" up in a small cairn of rocks at grade; also a standard white poly 'T' marker post 5" North. I secured the monument for new ties as found loose in rocks cairn.

In September 1859, William E. Daugherty/GLO set a wood post as the original corner and noted OBTs: an 8" Bw N10°W 17 links and an 8" Bw S35°E 12 links; all are now gone.

In February 1947, A.J. Lytle monumented GLO corner location from SE GLO OBT, noted as being SW, with a 2" dia. galvanized iron pipe with stamped brass cap and marked a new BT 24" Pw N89.5°E 62 links, which I found OK for new ties but did not find any reliable evidence of the SW GLO Bw OBT.

In March 1947, F.R. Wincentsen/RLS 155 notes a brass capped iron pipe at corner, GLO Bw BT S35°W and Lytle's NE Pw BT per Page 281 of Book 1 of Wincentsens field notes in Oneida County records.

In July 1999, Michael Weber/RLS 2070 notes brass capped iron pipe monument found per Plats of Survey filed as C-1621 and C-1932 filed in Oneida County survey records.

This recovery completed August 18, 2003; there were no direct witnesses.

Plan view map of monument location with bearing and distance ties to a minimum of four(4) described witness or reference monuments of concrete, natural stone, iron, live bearing trees or equivalent material. If applicable, also show a minimum of two(2) bearing and distance ties to any other monument found and not accepted; including the bearing and distance from the accepted monument.

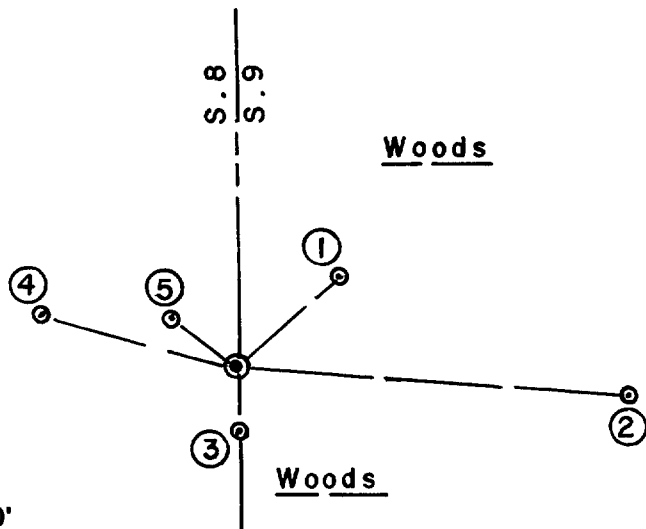

WITNESS MONUMENT TIES:

- ① Older 6.5" Mr BT with upper & lower face blazes open and old 40d nail in left face, N47°E 14.59'.
 - ② Older 28" Pw BT with a long open and scribed face blaze S86°E 41.04'.
 - ③ Older 8" Mr BT with upper and lower face blazes open and 40d nail in right face, South 6.90'.
 - ④ Older 16" Fir BT with upper and lower face blazes open, N74°W 21.10'.
 - ⑤ Older 12" Mr BT with upper and lower face blazes open and 40d nail in left face, N52°W 8.35'.
- I painted all old blazes orange and nailed a standard BT sign to upper face of BTs at 2 and 4.

SCALE: 1" = 20'

Unless otherwise indicated, all bearing tree ties are to a .25" dia. by 2.5" long PK nail with a 1.25" dia. steel washer driven into unblazed right face and a .25" dia. by 2.5" long PK nail with a 2" dia. steel washer stamped BT is also driven into unblazed face of bearing tree at DBH; the basis for measured bearings is by compass to nearest degree and all tie distances are measured horizontal by steel tape corrected to nearest 1/100th feet at standard temperature of 68° F.

RLS SEAL:



LAND SURVEYOR CERTIFICATE:

I, William C. Rohde, hereby certify that I am duly licensed as a Professional Land Surveyor in the State of Wisconsin; that this USPLS monument location was determined by me and/or under my direct supervision and control; and that this U.S. Public Land Survey Monument Location Record is true and correct to the best of my knowledge and belief.

Signed: *William C. Rohde*
 William C. Rohde RLS 841

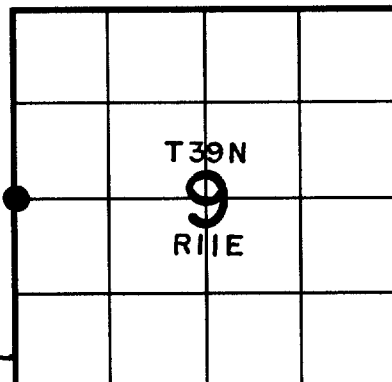

SECTION LOCATION MAP

INDEX NO. 69

3911082000