

Stock No. 26273

U.S. PUBLIC LAND SURVEY MONUMENT RECORD

Index No. F,6-19,20

State of Wisconsin

County of Oneida } ss.

I, Kip W. Soder, do hereby certify that on the 11th day of April, 1989, I found evidence of the Angle Pt., #7 corner of Section 11, Township 39 North, Range 11 East, Fourth Principal Meridian, as described hereon; and that from this evidence I established a new monument and accessories as described hereon to perpetuate the original location of this corner.

Resident witnesses:

Robert Conquest

History of original corner establishment: Original Government Survey in 1859 by William E. Daugherty.

Dependent resurvey in 1943 by the General Land Office of the originally meandered Lone Stone Lake. Set an iron post, 3' long, 1" dia., 27" in the ground with a brass cap marked; T39N, R11E, S11, A.P. 7, 1943, and witnessed by the following B.T.'s:

Spruce 9" N 63° E 37 lks.
Spruce 9" S 18°-45' E 21 1/2 lks.

Description of corner evidence found:

Found monument as described and in place.

No bearing trees

Description of monument and accessories I established to perpetuate the original location of this corner.

Blazed and scribed the following bearing trees;

Y. Birch 9" N 37° E 48.53 feet.
Maple 9" S 75° W 77.69 feet.

Set steel sign post 0.80' Northeast of corner.

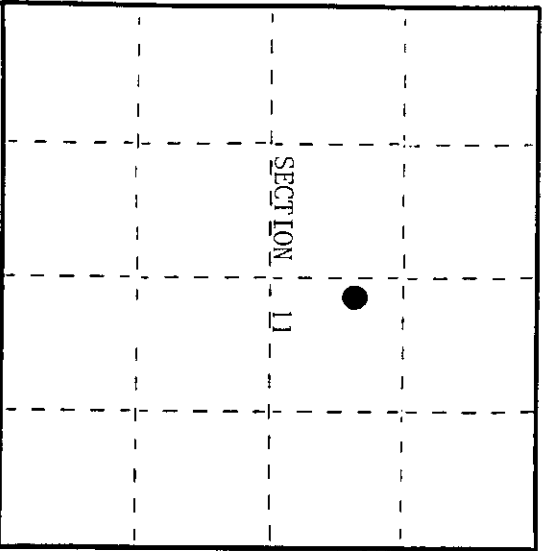

● = Corner monument restored.

Dated at Three Lakes Wis., this 8th day of May, 1989.

Signature Kip W. Soder Title Land Surveyor
(County Surveyor, Registered Land Surveyor, or other duly authorized official) Registration No. S-1731

Office of Register of Deeds, County of Oneida, I hereby certify that the within instrument was filed in this office for record on the 19th day of May, 1989 at 10:00 o'clock A.M.

(Register of Deeds)

By Deputy

391112719

(j) Describe any material discrepancy between the location of the corner as restored or reestablished and the location of that corner as previously restored or reestablished by distance and direction. Show the discrepancy on the plan view drawing under (d), above. Show the distances between the corner as previously restored or reestablished and (1) the corner as restored or reestablished, and (2) to at least 2 of the witness monuments shown on the drawing in (d), above.

See drawing below.

(f) Was the corner restored through acceptance of (1) an obliterated evidence location, or, (2) a found perpetuated location?

Restored through acceptance of a found perpetuated location.

(g&h) Was the corner reestablished through lost corner proportionate methods? If so, show the method, including the directions and distances to other public land survey corners used as evidence or used for proportioning in determining the corner location?

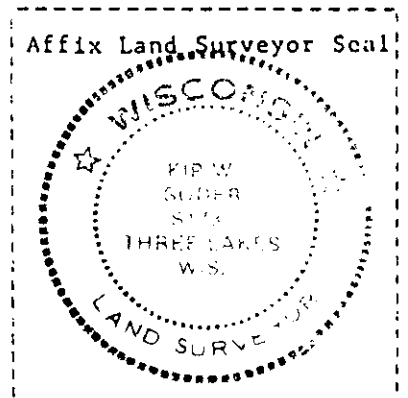
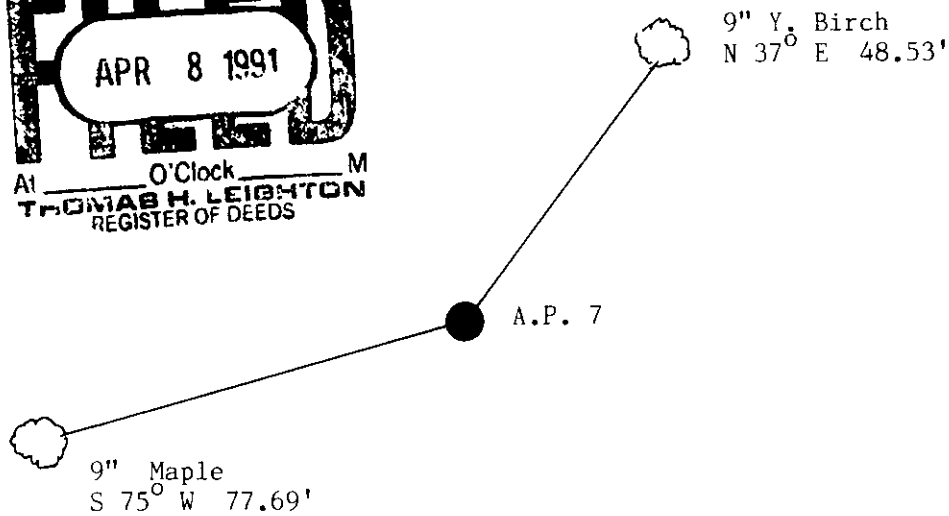
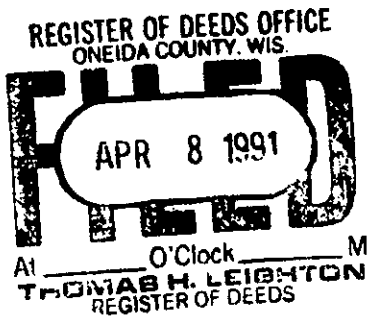

(i) I, Kip W. Soder (type or print name) certify that the corner location shown on this record was determined by me or under my direction and control and that this U.S. Public Land Survey Monument Record is correct and complete to the best of my knowledge and belief.

Kip W. Soder Nov 9, 1990  
Signature Date

Survey requested by: Jim York 1/3/90  
District Ranger Date